

# **Classical Tahoe**

**WADMIN21-0004**

- Classical Tahoe proposes to hold it's 10th anniversary festival on the Sierra Nevada University campus beginning July 27th and ending on August 15th.
- Concerts will be held on July 30th, 31st, August 1st, 6th, 7th, 8th, 10th, 12th, 13th, 14th, and 15th. All other dates listed in the permit application are rehearsal dates that are open to the public, free of charge.
- On July 23rd and 24th, Classical Tahoe will also host Tahoe Dance Camp, a non-profit organization whose mission is to bring world-class dancers, choreographers, and other artists to Lake Tahoe to freely create, collaborate, and perform. Tahoe Dance Camp is founded by Incline Village resident, [Sarah Van Patten](#), who also serves as the Artistic Director.

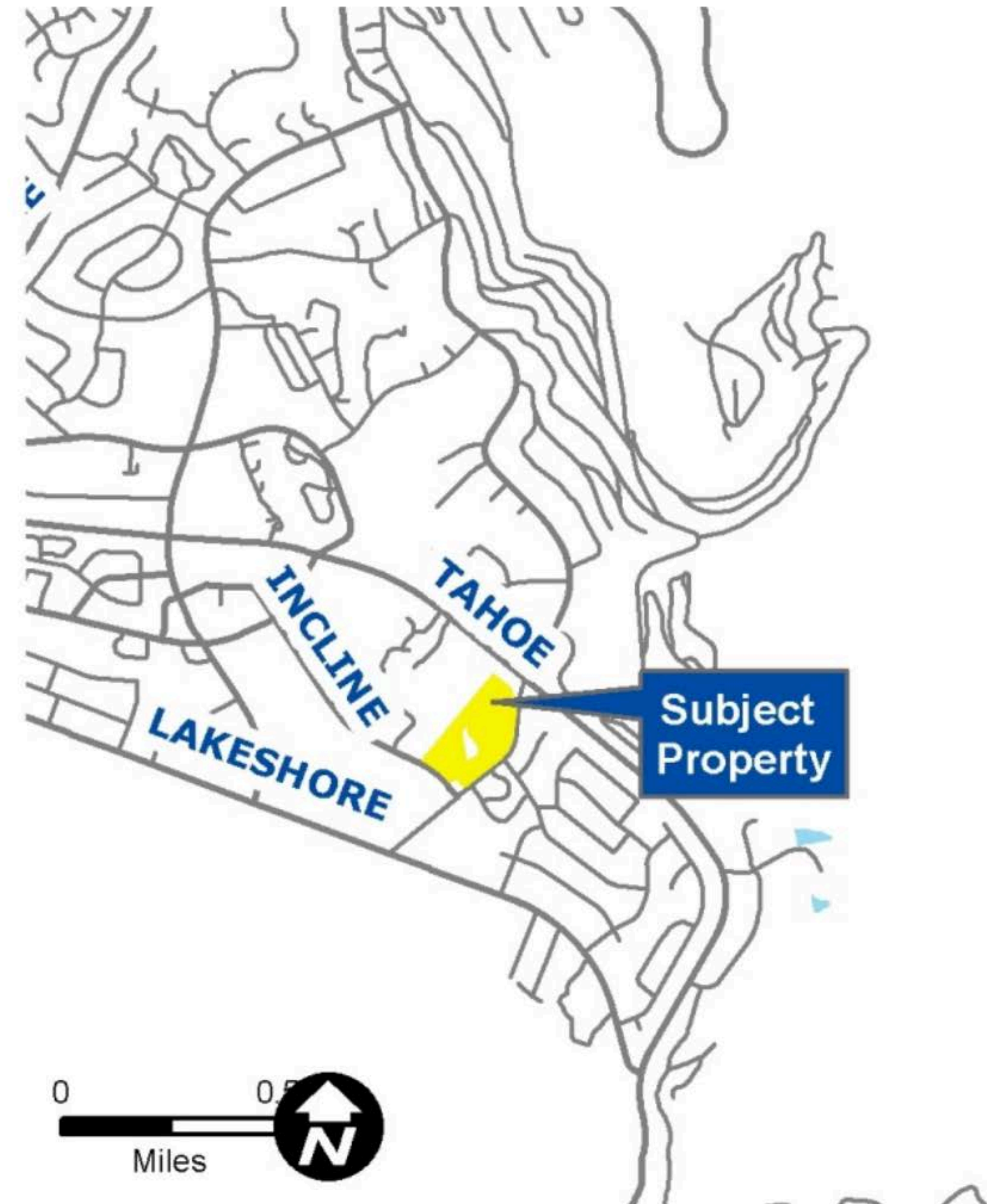

**Vicinity Map**



- Classical Tahoe erects a main tent membrane structure for the three week festival, as well as additional auxiliary tents for the courtyard area.
- The structure is built on the SNU campus between Primm Library and Patterson Hall.
- A building permit is already in process for this event.
- All rehearsals and performances are held within this main tent structure.





- For 2021, Classical Tahoe will be removing one wall of the tent structure to have an amphitheater style event, with the musicians located under the tent structure, and patrons located in the open air.



- At this time, the orchestra will not be amplified, however there will be amplified speech during performances.
- If the musicians are not audible in the very back rows of the audience, we request to be allowed light amplification to those areas only so those patrons can have a good experience. The sound will not be heard beyond the SNU campus at any time.

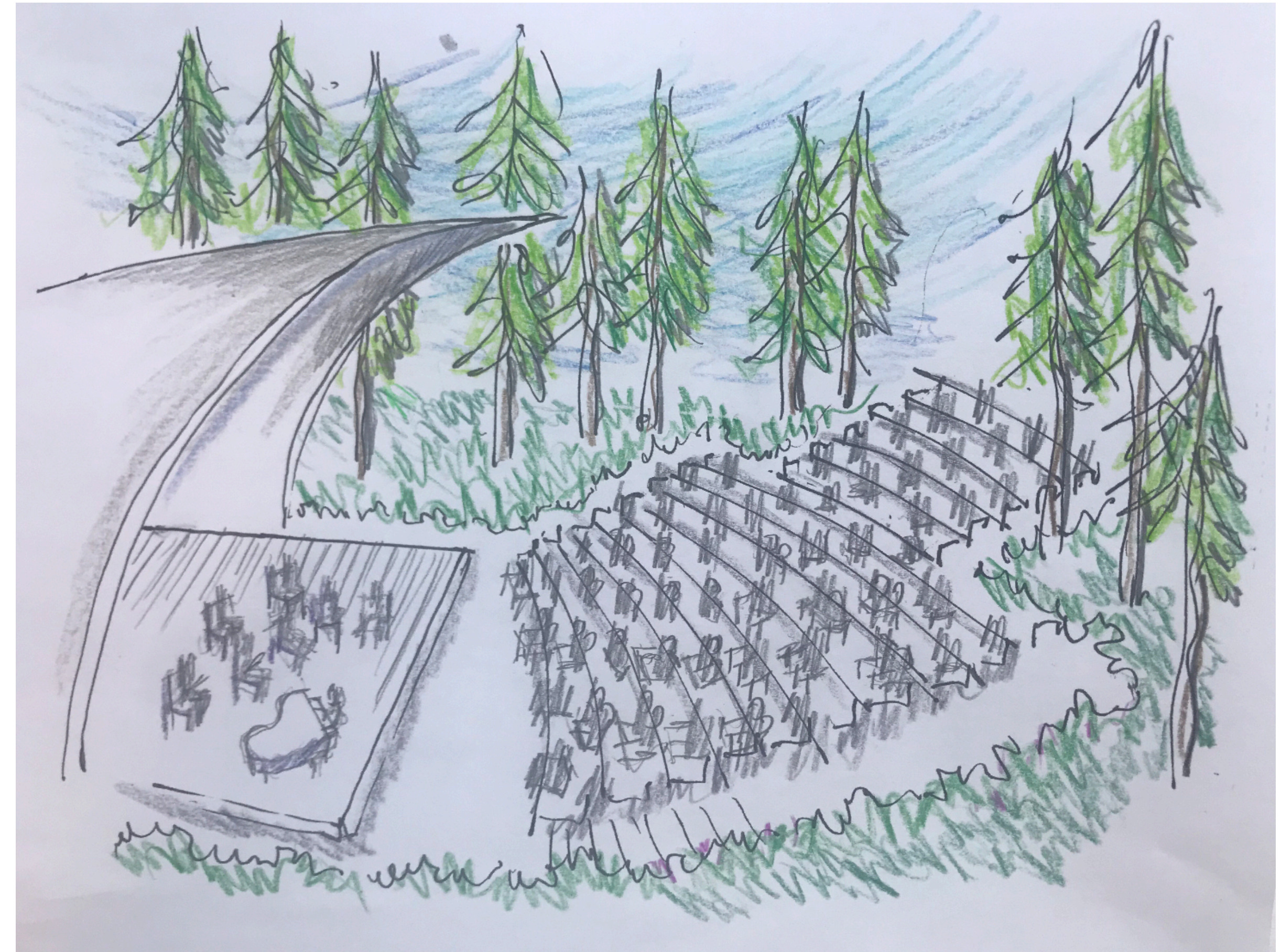



- Patrons will all be seated in pairs, distanced three feet apart from other patrons. This allows our house capacity to be 372 patrons.
- All patrons will also be seated offset from the rows in front, as demonstrated here, for best possible spacing and visual impact.
- Classical Tahoe will continue to follow all Washoe County and State of Nevada COVID guidelines for our event, including health screenings, masks, sanitation, etc.

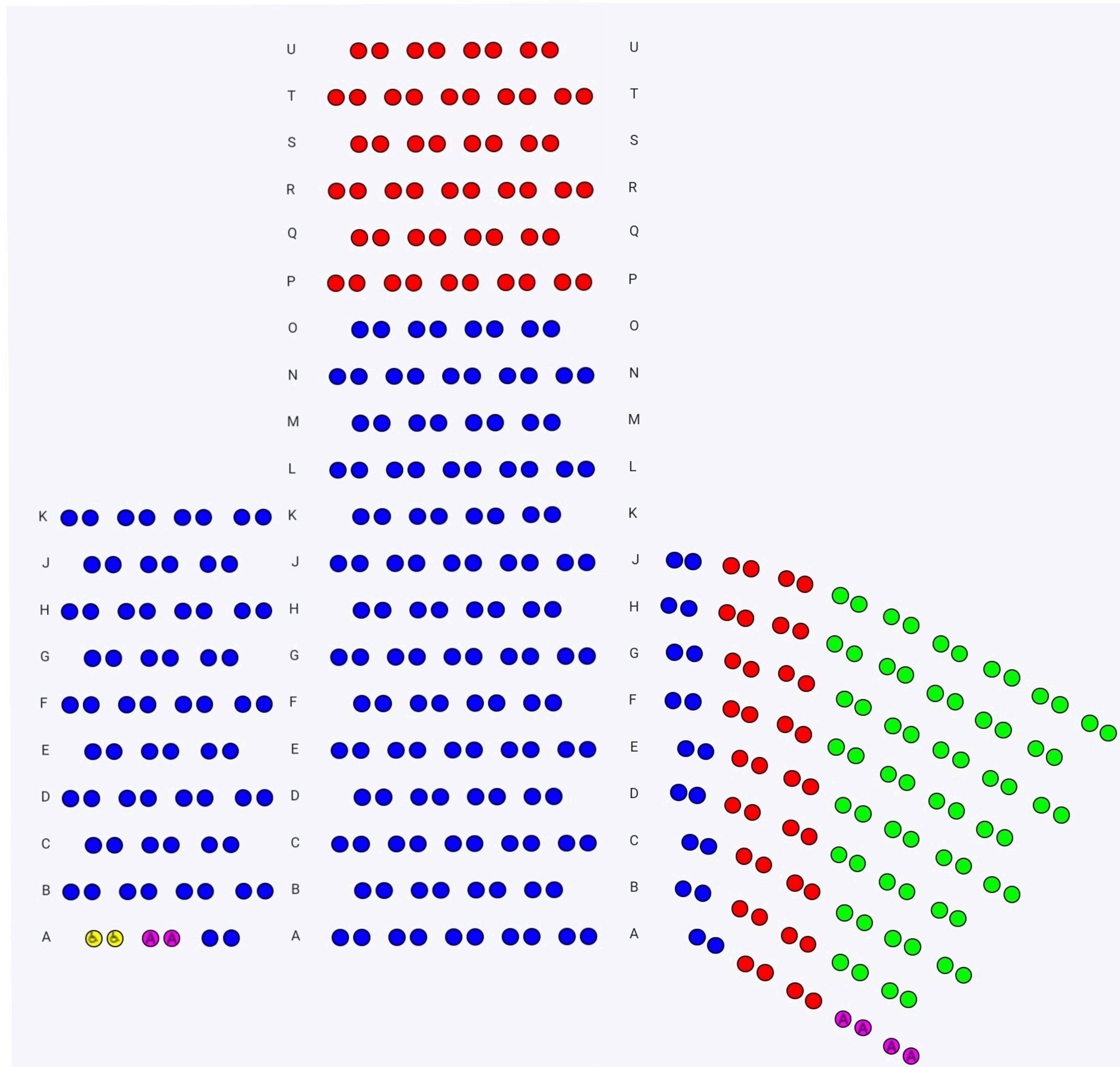



- Sierra Nevada University campus has a total of 238 public parking spaces in the two lower parking lots. We have also identified an additional 100 parking spaces in their upper parking lot we can use for overflow parking if needed. This gives us a total of 338 parking spaces.
- Classical Tahoe has 65 musicians and staff present during each concert, and 372 patrons during a sold out concert. This is a grand total of 437 people on site at our largest capacity.
- Historically, Classical Tahoe has not needed more than 200-225 parking spaces during concert events, as patrons and musicians arrive in pairs of 2 or more.
- Classical Tahoe will not need use of the IVGID Recreation Facility parking facility.





- Classical Tahoe plans to use Sierra Nevada University bathroom facilities during the three week festival. These will be open and available before, during, and after the performances and rehearsals.
- All event structures are scheduled to be removed and grounds restored by August 28th, per our agreement with SNU. The tent structures will be dismantled by August 24th.
- All orchestra rehearsals are scheduled between 10:30am-1:30pm, and all performances are scheduled between 7pm and 9:30pm. All activities end no later than 10:30pm.
- All additional utilities needed are serviced by NVEnergy and Waste Management, and provided by Classical Tahoe.